

Aspera R30



User Manual

Contents

1	General Information	5
1.1	Profile.....	5
1.2	Safety Information	5
1.3	Safety warning and Attentions	5
1.4	Getting to know your phone.....	8
2	Getting started.....	9
2.1	Installing the SIM Card and the Battery.....	9
2.2	Menu icons	10
2.3	Installing SD Card.....	13
2.4	Charging the Battery	13
2.5	Powering On/Off the Mobile Phone.....	16
2.6	Linking to the Network	16
2.7	Making a Call and adjusting call volume.....	16
2.8	Using the Headset	18
3	Input method	18

3.1	Icons for Input Methods	18
3.2	To Change Entry Methods	19
3.3	Numeric Input	19
3.4	English input and numeric input:	19
3.5	Inserting a Symbol	20
4	Using the Menus	21
4.1	Messages	21
	Write message	21
	Conversations	21
	Drafts	22
	Sent messages	22
	Delete messages	22
	Broadcast messages	22
	Templates	23
	Message settings	23
4.2	Phonebook.....	23
4.3	Call history.....	24
	Missed Calls.....	24
	Dialed Calls.....	24

Received Calls	24
Delete call logs.....	24
4.4 Multimedia.....	25
Camera	25
Image Viewer	25
Video Player.....	25
Photo editor	25
FM radio	26
Setting up User profile.....	26
Settings.....	29
Security Settings	30
4.5 File manager.....	31
4.6 Organizer.....	32
Calendar	32
Tasks	32
Alarm.....	32
4.7 SOS.....	33
SOS Settings	33

1 General Information

1.1 Profile

Please read this manual carefully to help you make the most of your phone. Our company may change features of this mobile phone without prior written notice and reserves the final right to interpret the performance of this mobile phone. Due to different software and network operators, display on your phone may be different, refer to your phone for details.

1.2 Safety Information

If your phone has been lost or stolen, notify your network service provider and the SIM card will be disabled (network support is required). This can avoid economic loss caused by unauthorised use.

1.3 Safety warning and Attentions

Safety warning

> Road safety comes first

Do not use a hand-held phone while driving. Use hands-free fittings when calls are unavoidable while driving. In some countries, dialing or receiving calls while driving is illegal. Please check with your local authorities regarding using a mobile phone while driving.

> Switch off in aircraft

Wireless devices can cause interference in aircraft. Please make sure to only use your phone when switched to Flight mode when in an aircraft. Go to Menu → Settings → Phones settings → Flight mode

> Switch off before entering risk areas

Strictly observe the relevant laws, codes, and regulations on the use of mobile phones in risk areas. Turn off your mobile phone before entering a place susceptible to explosion, such as an oil station, oil tank, chemical

plant or a place where a blasting process is under way.

➤ **Observe all special regulations**

Follow any special regulations in force in any area such as hospitals and always switch off your phone whenever it is forbidden to use it or, when it may cause interference or danger. Carefully use your mobile phone near medical apparatuses, such as pacemakers, hearing aids and some other electronic medical devices, as it may cause interference to such apparatus.

➤ **Interference**

The conversation quality of any mobile phone may be affected by radio interference. An antenna is built inside the mobile phone and located near the microphone. Do not touch the antenna area during a conversation, this will cause conversation quality to deteriorate.

➤ **Qualified service**

Only qualified Aspera personnel or approved agent may install or repair phone equipment. Installing or repairing the mobile phone yourself may void the warranty.

➤ **Accessories and batteries**

Use only Aspera approved accessories and batteries. (Batteries only have 6 months warranty)

➤ **Emergency calls**

Ensure the phone is switched on and in service, enter the emergency number, e.g. 000, then press the Dial key. Give your location and state your situation briefly. Do not end the call until told to do so. The emergency number can be dialed with or without a sim card installed.

Precautions

This mobile phone has an intricate design. Please exercise special care when using it. The following

suggestions will help your mobile phone survive the warranty period and extend its service life:

- Keep the mobile phone and all its fittings beyond young children reach.
- Keep the mobile protective seal closed to prevent liquid and dust getting inside the phone.
- Do not use or store the mobile phone in dusty places, active parts of the mobile phone may be damaged.
- Do not store the mobile phone in a high-temperature place. High temperature may shorten the life of electronic circuits and damage the battery and some plastic parts.
- Do not store the mobile phone in extreme cold places. This will cause moisture to be formed inside the mobile phone and may damage electronic circuits when the mobile phone is moved to a constant temperature place.
- Do not throw, knock or shock the mobile phone, as that may cause damage to the internal circuits and high-precision components of the mobile phone.

1.4 Getting to know your phone



2 Getting started

2.1 Installing the SIM Card and the Battery

Using the tool provided or a flathead screwdriver
To rotate the screws anticlockwise and open the back cover.



1

2

Insert the Sim Card as per diagram below



Insert the battery as per diagram below

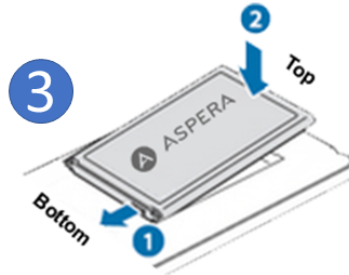

3

Using the tool provided or a flathead screwdriver
To rotate the screws clockwise to close back cover.



4

2.2 Menu icons

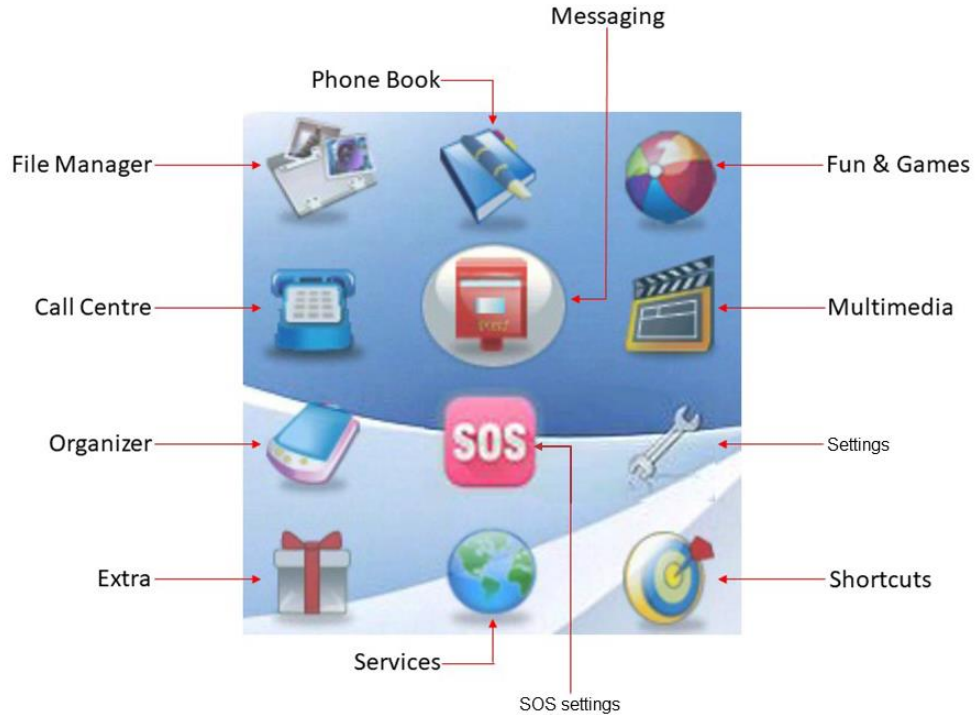

A SIM card carries useful information, including your mobile phone number, PIN (Personal Identification Number), PIN2, PUK (PIN Unlocking Key), PUK2 (PIN2 Unlocking Key), IMSI (International Mobile Subscriber Identity), network information, contacts data, and short messages data.

Note: After powering off your mobile phone, wait for a few seconds before removing or inserting a SIM card.

Exercise caution when inserting a SIM card, as friction or bending may damage the SIM card.

Keep the mobile phone and its fittings such as the SIM cards beyond children's reach.

Installation

- ❖ Open the flip, press & hold the power button for 5 seconds to switch off the phone.
- ❖ Remove the back cover by using tool provided in the box or you can use a flathead screwdriver & turn the screws anticlockwise to open.
- ❖ Pull the battery up from the top center and then lift the battery away.
- ❖ Insert the SIM card into the SIM card slot lightly with the corner cutting of the card aligning to the notch of the slot and the gold plate of the card facing downward aligning the sim card connectors with those of the phone.
- ❖ With the metallic contacts of the battery facing the metallic contacts in the battery slot, press the battery down until it locks into place. You can then re-install the back cover.

❖ **Using code**

The mobile phone and the SIM cards support passwords, to prevent the phone and the SIM cards from unauthorized usage. When you are prompted to input any of the codes mentioned below, just input the correct code and then press the ok key. If you input a wrong code, press the Right soft key under the screen to clear it and then input the correct code.

❖ **Phone lock code**

The phone lock code may be set to prevent your mobile phone from being misused. In general, this code is provided along with the mobile phone by the manufacturer. The initial phone lock code is set to 0000 by the manufacturer. If the phone lock code is set, you need to input the phone lock code when powering on the mobile phone.

❖ **PIN**

The PIN (Personal identification number, 4 to 8 digits) code prevents your SIM card from being used by unauthorized people. In general, the PIN is supplied with SIM card by the network operator. If PIN check is enabled, you need to input the PIN each time when you power on your mobile phone. The SIM card will be locked if you input wrong PIN code three times.

Unlocking methods as follows:

- Input the correct PUK according to the screen tips to unlock the SIM card.
- Then input the new PIN and press the ok key.
- Input the new PIN again and then press the ok key.
- If the input PUK is correct, the SIM card will be unlocked, and the PIN will be reset.

***Note:** The SIM card will be locked if you input wrong PIN code three times. To unlock the SIM card, you need to input the PUK. In general, the PUK can be obtained from the network operator.*

❖ **PUK**

The PUK code (Personal Unlocking Key) is required to change a blocked PIN. It is supplied with the

SIM card. If not, contact your network operator. If you input the wrong PUK code for 10 times, SIM card will be invalid. Please contact the network operator to replace the SIM card.

❖ **Barring code**

A barring code is required for setting the call barring function. You can obtain this code from the network operator to set the call barring function.

2.3 Installing SD Card

An SD card is a mobile storage card that can be installed inside the mobile phone.

To install an SD card, slide the metal cover and lift, insert the card into the card slot and lock the metal cover.

To remove the SD card, slide the metal cover, lift and remove the SD card.

Note:

1. The mobile phone cannot automatically identify the SD card being inserted when the mobile phone is powered on. You must power off the mobile phone and then power it on, so that the phone can identify the SD card.

2. The SD card is a small object. Keep it out of the reach of small children for fear that they may swallow it.

2.4 Charging the Battery

The lithium-ion battery delivered with the mobile phone can be put into use immediately after being unpacked. At first charge please charge it fully by placing the phone in the cradle for 6 hours or till the green light on the cradle appears.

Battery level indication:

❖ Your mobile phone can monitor and display the battery state.

❖ The remaining energy of the battery is indicated by the battery level icon at the upper right corner of the

display screen.

- ❖ When the battery energy is insufficient, the mobile phone prompts "Battery low". If you have set an alert tone, an alert tone will be given off when the battery level is too low.
- ❖ A charging animation appears when the battery is being charged.
- ❖ Install the battery into the mobile phone before charging the battery.
- ❖ Connect the adapter of the travel charger with the charging port in the mobile phone. Ensure that the adapter is fully inserted.
- ❖ Insert the plug of the travel charger to an appropriate power outlet.
- ❖ During the charging, the battery level grids in the battery icon keep flickering till the battery is fully charged.
- ❖ The battery icon will no longer flicker when the charging process is complete.
- ❖ **NEVER LEAVE THE PHONE PLUGGED IN CHARGE OVERNIGHT OR FOR MORE THAN 6 HOURS.**

Note:

Ensure that the plug of the charger, the plug of the earphone, and the plug of the USB cable are inserted in the right direction. Inserting them in a wrong direction may cause charging failure or other problems. Before charging, ensure that the standard voltage and frequency of the local mains supply match the rated voltage and power of the travel charger.

Using the Battery

The performance of a battery is subject to multiple factors: radio network configuration, signal strength, ambient temperature, chosen functions or settings, phone fittings, and the voice, data or other application

mode you choose to use.

To guarantee the optimal performance of your battery, please stick to the following rules:

- ❖ Use only the battery provided by Aspera. Otherwise, damage or even injuries could be caused during charging. You may also void the warranty.
- ❖ Power off the mobile phone before removing the battery.
- ❖ The charging process may take more time for a new battery.
- ❖ If the battery voltage is too low to enable the mobile phone to be powered on, charge the battery for a longer time. In this case, the battery icon does not flicker until a long time after the battery enters the charge status.
- ❖ During charging, ensure the battery is placed in a room temperature environment or in an environment close to room temperature.
- ❖ Immediately stop using the charging process if the battery produces odor, overheats, cracks, distorts or has other damage, or if the electrolyte leaks.
- ❖ The battery wears out with use. A longer charging time is required as the battery is put into use for a long time. If the total conversation duration decreases but the charging time increases even though the battery is properly charged, purchase a standard Aspera battery. Using any poor-quality fittings will cause harm to your mobile phone and may be dangerous.

Note: *To guarantee your personal safety and protect the environment, be careful if disposing of the battery. Return the old battery to Aspera or place it in specified battery reclamation areas. Do not dispose of the battery with normal household waste.*

Warning: Short-circuits of the battery may cause explosion, fire, personal injury or other severe

consequences.

2.5 Powering On/Off the Mobile Phone

Press and hold power button for 5 seconds to power on the mobile phone.

A power-on animation appears on the display screen displaying the ASPERA logo.

The R30 is unlocked and does not require a pin to unlock it, apart from if you have a pin lock on your sim card. The original code for phone unlock is 0000.

Input the PIN and press the ok key if the mobile phone prompts you to input the sim card PIN. The PIN is provided by the network operator for new opening SIM card.

Enter the standby interface.

To power off the mobile phone, press and hold power button for 5 seconds.

2.6 Linking to the Network

After the SIM card is inserted and the mobile phone is successfully unlocked, the mobile phone automatically searches for an available network. After finding a network, the mobile phone enters the standby state. When the mobile phone is registered on the network, the name of the network operator is displayed on the screen. Then you can dial or receive a call.

2.7 Making a Call and adjusting call volume

In the standby interface, press number keys to input the area code and the telephone number, and then press the Dial key to dial a call. To end the call, press the End key. To increase the volume, press up the “Shortcut / Navigation Key” or to decrease the volume, press the “Shortcut / Navigation Key” down.

❖ Dialing an international call

Press the * key twice to input "+". Then input the country code, the area code and the telephone number.

Finally, press the Dial key.

❖ **Dialing to a number in the phonebook**

Enter the phonebook by pressing the key under Names which is displayed at bottom right of the screen and use the navigational direction keys to find the telephone number you want to call. Once in the Phone book you can also enter a letter to bring up all Contacts starting with that letter. Scroll to the desired Contact.

Press the green Dial key. The mobile phone automatically dials the chosen Contact.

You can also access the phone book directly by pressing the bottom section of silver around the center menu button.

Redialing the last number

In the standby interface, press the dial key to show the dialed calls.

Press the up or down direction keys to select a number you want to dial and then press the Dial key.

❖ **Answering incoming calls**

To answer an incoming call simply open the flip on the R30 or if the flip is already opened, Press the green key to answer an incoming call.

***Note:** If the caller can be identified, the mobile phone will present the calling number. If the calling number exists in the phonebook, the mobile phone will present the name of the caller. If the caller cannot be identified, the phone number will present only. You can answer an incoming call when using a function list or browsing the phonebook.*

❖ **Using options during a conversation**

Select Options during a conversation to pause, end the ongoing call, originate a new call, browse the phonebook, view information, set the mute, set the DTMF, or perform other operations. You can even create a conference call between 3 people by making a new call during an existing call, then select Options – Conference.

2.8 Using the Headset

The phone will enter headset mode automatically when you insert headset to the port. A message will pop up on the screen “Earphone plugged in.” Make sure you insert the headset tip to the bottom of the headphone jack, so you can listen to a call or audio files clearly.

3 Input method

The Aspera R30 provides multiple input methods, including English, Spanish and Chinese languages and numeric input. You can use these input methods when editing the phonebook, short messages, files and so on.

3.1 Icons for Input Methods

After you enter an edit window such as a window for editing the phonebook or SMS messages, the input method is displayed at top left of the screen to indicate the current input method:

Numeric input: “123”

English input in upper case: “ABC”

English input in lower case: “abc”. There is also eZi text which predicts words you are trying to type.

You can choose the input method by pressing the # key, it will display the input method at top left of screen.

3.2 To Change Entry Methods

Press the # key to switch between input methods.

3.3 Numeric Input

You can input numbers with the numeric input method. Press # key until the 123 icon shows then press a number key to input the corresponding number.

3.4 English input and numeric input:

The keyboards for English input and numeric input are defined in the following table:

Key	Character or Function	Remarks
Number key 1	. , - ? ! ' @ : # \$ / _ 1	
Number key 2	ABCabc2	
Number key 3	DEFdef3	
Number key 4	GHIghi4	
Number key 5	JKLjkl5	
Number key 6	MNOmno6	
Number key 7	PQRSpqrs7	
Number key 8	TUVtuv8	

Number key 9	WXYZwxyz9	
Number key 0	0	
* key	Press it to input a symbol	
# key	Press it to switch between input methods	
Left soft key	Equivalent to OK or Options	
Right soft key	Equivalent to Back or Clear	
End key	Press it to return to the standby interface	

English input:

- ❖ Each key is used to represent multiple characters. Quickly and continuously press a key until the character you want appears. Input the next character after the cursor moves.
- ❖ Smart English or predictive text input is available as an input option, press the # key until the blue eZi indicator appears before Abc.
- ❖ Press the # key to switch between input methods
- ❖ To clear wrong inputs, press the **Right soft** key under the word Clear.

3.5 Inserting a Symbol

Press the * key to enter the **Select symbol** interface, use direction keys to select a symbol you want.

4 Using the Menus

4.1 Messages

The phone supports Short Messaging Service (SMS) and Multimedia Message Service (MMS). You can send text messages and manage the messages that you send and receive.

In the message, select the option to see options for that message.

Write message

- ❖ **New SMS:** Got to Messaging by clicking the menu button. Select messaging. In this menu, you can edit and send new messages. The characters for every message can be up to 160.
- ❖ **New MMS:** select to create a new message, set the telephone number of the recipients or select the Contact, and synchronously edit the content of SMS. Select Options then select add picture, add sound, or add video. You can then send the message as an MMS or Picture message.

Conversations

In the inbox, you can store all the received text messages, and it will display the names of the senders. In the case that the sender is not included in the phonebook, it will display the telephone number of the sender.

The options for a single message include: **reply, delete, Call, etc.**

- ❖ **Reply:** Reply to the short message or MMS
- ❖ **Delete:** Delete the short message.
- ❖ **Call sender:** Call the number in the short message.
- ❖ **Mark:** Mark the current message or mark all.

You cannot receive new messages if the memory for messages is full. Delete unnecessary messages.

Drafts

Choose the Draft Messages, press the up key and the down key to select and press the left soft key to enter the Options.

- ❖ **Edit:** edit the current selected message.
- ❖ **Delete:** delete this message
- ❖ **Mark:** mark the current message or mark all.

Sent messages

Set to save sent messages to the SIM card or to the phone.

Select to save and send in sending messages and the sent messages will be saved in the Outbox.

This is to preserve once the message has been sent.

Delete messages

Delete the short message.

Broadcast messages

Broadcast messages are messages that your network operator broadcasts to all users within an area, such as a hazard event or transportation conditions.

- ❖ **Receive mode:** Enable or disable the function.
- ❖ **Read messages:** Scroll to read broadcast messages.
- ❖ **Note:** All Multimedia messages are stored in the memory of the mobile phone instead of SIM card, delete them from time to time to free up storage space.

Templates

There are 10 text messages preset in this mobile phone, and they can be edited or deleted, with not more than 40 characters per message.

Message settings

❖ Text message settings

Memory status: Display SIM card and Phone status.

Preferred storage: Set to save short messages to the SIM card or to the phone.

Please refer to Inbox for other operations.

Save sent message: After sending messages, ask to store.

Voicemail server: Dial the voice mail number to access your voice mail. The number is provided by your network operator. The voicemail number is automatically saved to speed dial. Press 1 for a few seconds to dial it.

4.2 Phonebook

The Aspera R30 can store up to 500 telephone numbers. The number of telephone numbers that a SIM card can store depends on the storage capacity of the SIM card. The telephone numbers stored in the mobile phone and in the SIM card form a phonebook.

After selecting a telephone number in the phonebook, select **Options** to perform the following operations:

❖ **Edit:** Edit the selected number and name.

- ❖ **Delete:** Delete the telephone number from the phonebook by clearing all details.
- ❖ **Sent text message:** sent text message to the selected number.
- ❖ **Call:** call the current number of the SIM.

4.3 Call history

Missed Calls

You can view a list of the latest missed calls.

Note: When the mobile phone indicates that some calls are missed, you can select **Read** to enter the missed calls list. Navigate to a missed call and then press the **Dial** key to dial the number that originated that call.

Dialed Calls

You can view the latest dialed calls. Simple press the green dial key and then select a dialed call to delete, save, dial, or edit (or send a short message to it).

Received Calls

You can view the latest received calls. Simple press the green dial key and then select a received call to delete, save, dial, or edit (or send a short message to it).

Delete call logs

You can delete the latest call records. Press the green dial key, then Options, and then select to delete the desired call record.

4.4 Multimedia

Camera

The Aspera R30 has a inbuild digital camera to allow user capture videos & take photos, to access the camera, select “Menu” scroll to “Multimedia” and select “OK” this will switch the camera on to take photos.

User can switch to video recorder by pressing down on the “Shortcut / Navigation key”, to return to camera press up on the “Shortcut / Navigation key”.

Image Viewer

Select Image viewer to see the captured images in your Aspera R30. You can navigate through your images by pressing up/down on the “Shortcut / Navigation key” and press “Select Key” to enlarge the image for viewing, to return to image thumbnails press the “Names / Contacts key” once.

Video Player

Select Video Player to view captured videos in your Aspera R30. You can navigate through your Videos by pressing up/down on the “Shortcut / Navigation key” and press “Select Key” to play the video, to return to video thumbnails press the “Names / Contacts key” once.

Photo editor

You can edit the pictures or images through this function.

Sound recorder

The phone supports WAV, AWB and AMR. AMR uses a compression algorithm. So, in the same memory condition, it has longer recording time than WAV.

After accessing the sound recorder, you can press left soft key to perform the following operations:

- ❖ New record: select this function to record a new file.
- ❖ List: recorded files are listed in this menu.
- ❖ Settings: Through this function, you can set storage position and format for record files.

FM radio

You must use your earphones as an antenna for the radio. You can use the application as a traditional FM radio with automatic tuning and saved channels. Select Options then Auto Search to find all radio channels. Then select Channel list to see the channels. In FM radio interface, you can press top and bottom of center button tune volume, press center key to play/stop the current channel, press left or right arrows to move frequencies.

Setting up User profile

User profiles

Select “Settings” than select User Profiles. The Aspera R30 provides multiple User Profiles, so that you can customize some settings to adapt to specific events and environments.

Customize the user profiles according to your preference and then activate the user profiles. The user profiles

fall into five scenarios: General, Silent, Meeting, Outdoor and My style. General is the standard user profile. Click Options then Customise to choose ringtone, message tone, and the volume for each.

When you insert an earpiece to the mobile phone, the mobile phone automatically enters the Headset mode.

To setup or edit a User Profile please following the below steps,

Select “Menu” → “Settings” → “User Profiles” → scroll down to Profile you want to Activate or edited and press the select button, select “Activate” to set the profile as default or scroll down to “Customize” to edit the profile, or you can “Reset” the profile.

Call Centre setting

Call waiting: Select the Call Centre icon then Call Settings – Call Waiting. After you choose Activate, the mobile phone will contact the network. A moment later, the network will make a response and send a message to acknowledge your operation. If the call waiting function is activated, the network will alert you and the mobile phone screen will display the incoming call number if others are calling you while you are already in a conversation.

Call divert: this network function enables you to forward incoming calls to another number you can specify.

Call barring: The call barring function enables you to bar calls as needed. When setting this function, you need to use a network barring code, which can be obtained from the network operator. If the code is

wrong, an error message will be prompted on the screen. After selecting a call barring option, continue to select Activate or Deactivate. The mobile phone will prompt you to input the call barring code and then contact the network. A moment later, the network will make a response and send the operation results to the mobile phone.

❖ **Advanced settings**

Blacklist: Here you can turn on the Blacklist function to reject calls from chosen numbers. You can then create your Blacklist by adding the Blacklist phone numbers.

Auto redial: Set it to **On** or **Off** to enable or disable auto redial. If you set **Auto redial** to **On**, the mobile phone will automatically re-dial the number a moment later if the called party does not reply. The number of auto redial times can be set to a maximum of 10. In the auto re-dial period, you cannot dial other numbers. To end the auto re-dial process, press the **End** key.

Note: This function requires support from the network operator to which the SIM card is registered.

Call time reminder: You can set it as On or Off. And set single or circle tone in a call to make you know the time.

Auto quick end: You can set ON/ OFF and set a time (1~9999s) as your desire.

Reject by SMS: Reject an incoming call and reply the caller a short message.

Answer mode: Select an answer mode as per your need. This will determine if calls are answered when opening the flip or after opening the flip and pressing answer.

Settings

Phone Settings

- ❖ **Time and date:** set the date format, the time format, and detail time of the location.
Note: If you remove the battery from the mobile phone or if the battery energy was exhausted for a long time, you may need to reset the date and time when re-inserting the battery or powering on the mobile phone after recharging.
- ❖ **Schedule power on/off:** Set the time when the mobile phone will be automatically powered on or off.
- ❖ **Language:** Select the display language for the mobile phone. Options are English, Spanish, Chinese.
- ❖ **Display settings:** Users can access this item to set wallpaper, screen saver, power on/off display, etc.
- ❖ **Themes:** Users can change the look and feel of their Aspera R30 by selecting 1 of 3 preloaded themes.
- ❖ **Greeting text:** Greeting text is a welcome message displayed on your Aspera R30 whenever the handset is switched On, you can customize your greeting text by turning Greeting text on and then scrolling down to Greeting text and pressing select to change the text. Once you have completed entering your greeting text press the “Shortcut / navigation key” to select and then press ‘Done’ Select “yes” to save.
- ❖ **Dedicated Key:** In this menu user can setup shortcut to their most used functions of Aspera R30.
- ❖ **Auto update time:** Activate/deactivate this function as per your need.
- ❖ **Flight mode:** when this function is engaged, it will suspend the device's signal transmitting functions – thereby disabling the device's capacity to place or receive calls or text messages– while still permitting use of other functions that do not require signal transmission (e.g. games, built-in camera, MP3 player.)

Security Settings

This function provides you with related settings about safety use

❖ **SIM security**

PIN lock: To activate PIN lock, you need to input the correct PIN code, the default code is 0000. If you set PIN lock to On, you need to input the PIN each time you power on the mobile phone. In the case you input a wrong PIN for three consecutive times, you need to input the PIN Unlocking Key (PUK). The PUK is used to unlock and change the locked PIN. To obtain the PUK, contact the network operator.

Change PIN: To change PIN code of SIM card.

❖ **Phone security**

Phone lock: The function enables you to lock/unlock the phone. Entering password to switch on or off the phone. Password is required when the phone is locked. The password is 4 to 8 digits and the default is 0000.

Change password: to change phone password. Default is 0000.

❖ **Auto Keypad lock**

Use this function to turn keypad lock on/Off or select a duration when the keypad should lock itself automatically.

Connectivity

❖ **Bluetooth:** With Bluetooth, you can make a wireless connection to other compatible devices, such as mobile phones, computers, headsets and car kits. You can use the Bluetooth to send images, video clips, music, sound clips and notes, and transfer files from your compatible pc.

❖ **Internet tethering:** Connect your phone to another device with the USB cable and you can share your

mobile data connection.

- ❖ **Data account:** You can select the desired network account.

Restore factory settings

Use this function to restore factory settings. The preset password is 0000.

4.5 File manager

The phone provides a certain space for users to manage files and supports the Memory card. The capacity of the Memory card is selected by the user and can be up to 32GB. You can use the file manager to conveniently manage various directories and files on the phone and the Memory card.

- ❖ **Open:** Choose File manager to enter the root directory of the memory. The root directory will list the default folders, new folders and user files. When the mobile phone is powered on for the first time or when you have not changed the directory, the root directory contains the default folders only.
- ❖ **Format:** You can use this function to format all the data in the memory. The system will re-create a default folder. The formatted data cannot be recovered. Therefore, think twice before using the formatting function. If a SD card is not being read by the phone you may have to choose Format to format the SD card.

4.6 Organizer

Calendar

Once you enter this menu, there is a monthly-view calendar for you to keep track of important appointments, etc. Days with events entered will be marked.

Tasks

Use this function to create new memo, which you can view, add, edit, delete, delete overdue, delete all, jump to date, view uncompleted, send V-Calendar and saved as file. If you have set the alarm for the memo, alarm will sound when time is up, the content of memo will display at the same time.

Alarm

Five alarm clocks are set but deactivated by default. You can activate one, multiple or all of them as needed. For each alarm clock, the ringing date and the ringing time can be set.

You can get to Alarm settings directly by pressing the left arrow.

Notes

Add notes and edit or delete them.

World clock

Shows world time and time zones

4.7 SOS

SOS Settings

This function enables you to edit SOS settings.

Switch SOS On/Off: Scroll down to SOS icon and press select → Select “SOS mode settings” → Select On/Off and press the select key to save and exit.

SOS Message: Scroll down to SOS icon and press select → Select “SOS Message” edited the message as you wish and press the select key to save and exit.

Set SOS numbers: Scroll down to SOS icon and press select → scroll down to “Set SOS numbers” and select “OK” → select which entry 1,2,3,4 or 5 you want to edit and press select key, → Add, Delete or Edit the number you want SOS key to trigger and select “OK”, press “Back” key to go back to pervious menu.

Please visit our website for further instructions for the Aspera R30.

www.asperamobile.com

Email: info@asperamobile.com

Phone: 1300 656 456

Like us on Facebook www.facebook.com/asperamobile

Visit our Youtube channel www.youtube.com/asperamobilevideos